

# JR 330 SC



## Handsfree Accessibility Intercom



The rugged hands free intercom is designed to meet the needs of client who experience loss through vandalism. Ideal for parking lots, lifts/elevators, hotels, doorway, railway/metro platforms, hospitals, police stations, ATM machines, stadiums, outside building etc.

Housed in cold rolled steel box and manufactured to a high standard, these telephones offer increased resistance to vandalism, and ensure that the primary function of communications is maintained at all times.

Extremely easy to install. The cable entrance is on the back of the phone to prevent from artificial damage, while the keypad is weather and vandal resistant.

## Features

- Standard Analog / VoIP phone
- With LED status indicator light
- Robust housing, constructed of cold rolled steel
- Vandal resistant metal button
- Single button auto dial
- Hands free operation
- Wall mounted, simple installation
- Weather proof protection: IP55-IP65
- Phone line powered (Analogue)
- PoE, or 12V DC (SIP)
- RJ45 Port for SIP connection
- 4 X Tamper proof screws for mounting
- CE, FCC, IK10, RoHS, ISO9001 compliant



TDM Middle East LLC  
Regional Office: ADAFZ, Abu Dhabi, UAE  
Headquarters: Crawley, UK, RH10 9PD

[www.tdm-middle-east.com](http://www.tdm-middle-east.com)

[info@tdm-middle-east.com](mailto:info@tdm-middle-east.com)

## SIP-VoIP

- **Power:**  
12-24V DC, or POE: IEEE802.3af (Optional)
- **Port:**  
WAN: 10/100Base-T RJ-45 for LAN, Auto MDIX  
LAN: 10/100Base-T RJ-45 for PC, Auto MDIX
- **Power Consumption:**  
Idle: 1.5W/ Active: 1.8W

## Analogue

As a standard analogue telephone, this unit provides basic telephone functions and can be connected to any standard two-wire telephone line, including analogue PABX lines and PSTN.

- **Dialing:**  
MF TONE
- **Power:**  
From the Telephone Line
- **Lightning / Transients:**  
Protection to ITU-T k.21 enhanced Levels
- **Programming:**  
Can be programmed remotely by DTMF tone or using keypad

## Package

- Unit size: 530 \*280 \*200 (mm)
- Carton size: 200 \*300 \*440 (mm)
- Packaging materials: pearl cotton, carton
- Gross weight: 9.5 KG
- Net weight: 8.5 KG

## Voice Features

- Support SIP 2.0 (RFC3261)
- Codec: G.711A/u, G.7231 high/low, G.729, G.722
- Echo cancellation: Support G.168 and hand-free can support 96ms
- Supports full duplex.
- SIP support SIP domain, SIP authentication (none, basic, MD5), DNS name of server, peer to peer
- DTMF: SIP info, DTMF Relay, RFC2833
- Call control feature: Flexible dial map, support hot-line

## Network Features

- WAN/LAN: support Bridge mode
- Support static IP address
- Support DHCP get IP on WAN port
- Support VLAN
- Support web config
- Data Protocols: IPv4, TCP, UDP, ICMP, ARP, DNS and DNS SRV for SIP Signaling

## Technical Specification

- Casing Material  
Cold Rolled Steel
- Button Material  
Stainless steel button
- Microphone  
Electret microphone
- Built in Speaker  
80hm 0.5W
- Keypad  
Internal keypad for programming
- Temperature  
Operating: -30°C to +65°C  
Storing: -40°C to +75°C
- Weather Resistance  
IP55-IP65
- Ringing Tone  
Analog: Shrill warble tone 80 dBA @ 1 meter typical  
SIP: Shrill warble tone 90 dBA @ 1 meter typical
- M.T.B.F.  
Calculated to have an M.T.B.F. in excess of 50,000 hours using

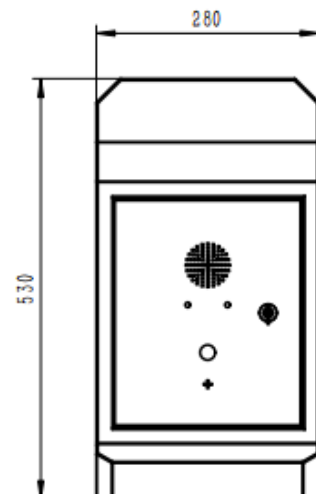
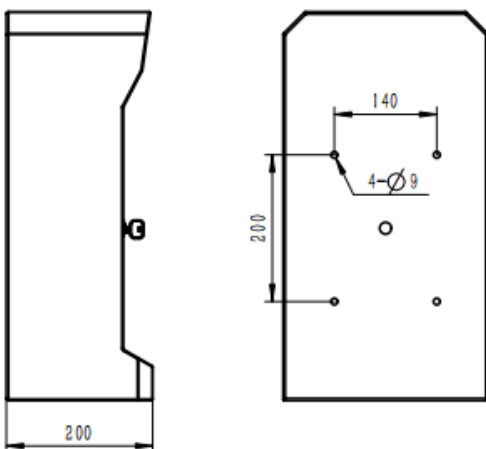

TDM Middle East LLC  
Regional Office: ADAFZ, Abu Dhabi, UAE  
Headquarters: Crawley, UK, RH10 9PD